

**Warning:**

Installation must be performed by a qualified motorcycle mechanic. Do not attempt to install if you do not have the necessary qualifications and skills. Injury or death may result from improper installation.

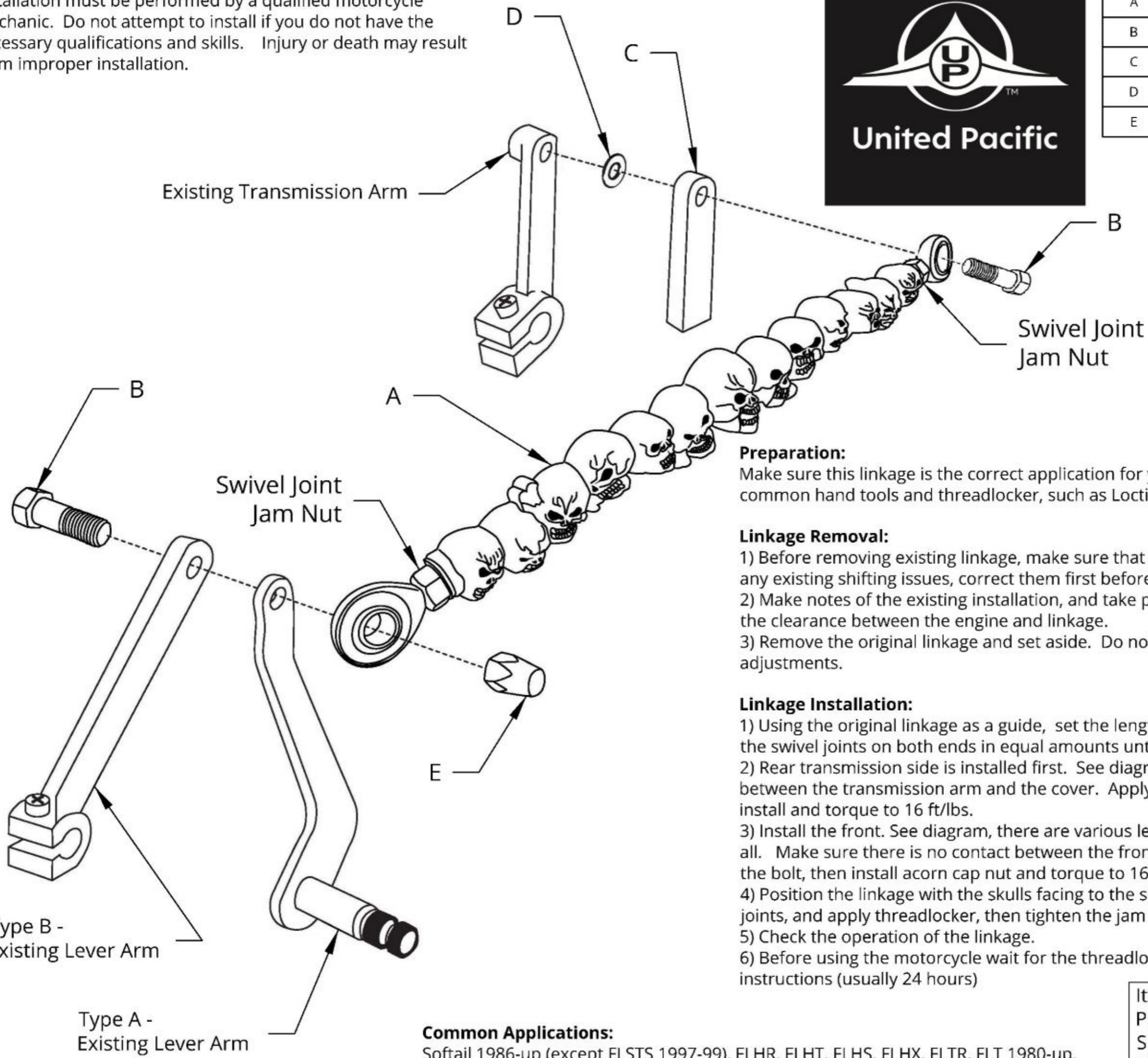

No.	DESCRIPTION	QTY in Kit
A	SKULL LINKAGE ASSEMBLY	1
B	HEX HEAD BOLT	2
C	TRANISMISSION ARM COVER	1
D	SPACER WASHER	1
E	ACORN NUT	1



**Preparation:**

Make sure this linkage is the correct application for your model. Installation requires common hand tools and threadlocker, such as Loctite® 243.

**Linkage Removal:**

- 1) Before removing existing linkage, make sure that shifting is working properly. If there is any existing shifting issues, correct them first before installing the new linkage.
- 2) Make notes of the existing installation, and take photos for reference. Also take note of the clearance between the engine and linkage.
- 3) Remove the original linkage and set aside. Do not change or rotate the length adjustments.

**Linkage Installation:**

- 1) Using the original linkage as a guide, set the length of the new linkage to match. Rotate the swivel joints on both ends in equal amounts until the length is matching the original.
- 2) Rear transmission side is installed first. See diagram. Note the small washer must be between the transmission arm and the cover. Apply threadlocker on the rear bolt, then install and torque to 16 ft/lbs.
- 3) Install the front. See diagram, there are various lever types, but installation is the same for all. Make sure there is no contact between the front bolt and engine. Apply thread locker on the bolt, then install acorn cap nut and torque to 16 ft/lbs.
- 4) Position the linkage with the skulls facing to the side. Back off the jam nuts on both swivel joints, and apply threadlocker, then tighten the jam nuts to 9 ft/lbs.
- 5) Check the operation of the linkage.
- 6) Before using the motorcycle wait for the threadlocker to cure per the manufacturers instructions (usually 24 hours)

**Common Applications:**

Softail 1986-up (except FLSTS 1997-99), FLHR, FLHT, FLHS, FLHX, FLTR, FLT 1980-up, FLH (various), FLHTCUTG 2009-up, and FXDWG 1993-02

Item No. 52009
Product Name: Skull Shift Linkage For Harley Davidson Motorcycle
Rev No. 04092020