

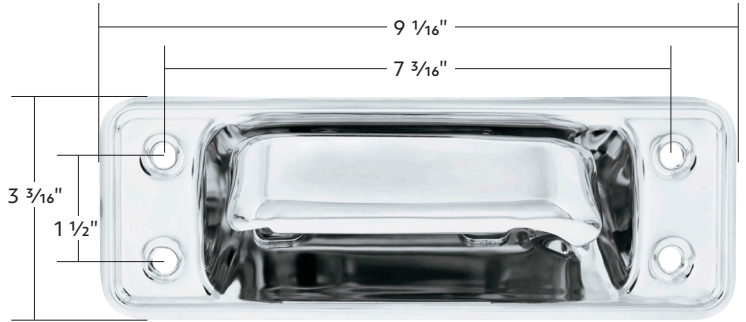

NEW ITEMS



1966-1977 Ford Bronco & 1964-1972 Truck

Tailgate Handle Assembly

- Excellent quality steel reproduction of the original
- Easy to install, simply connect tailgate's two latch rods and mounts with existing screws (not included)
- Mounting gasket included

110905	Stainless Steel	1 Pc. / Wbox
110956	Black	1 Pc. / Wbox



1966-1977 Ford Bronco & 1967-1979 Truck

Black Exterior Mirror

- Exceptional quality zinc die-cast
- Satin black mirror housing and mounting arm
- Includes mounting pad and screws
- Fits left hand or right hand side

111010	Black Exterior Mirror	1 Pc. / Cbox
---------------	------------------------------	--------------



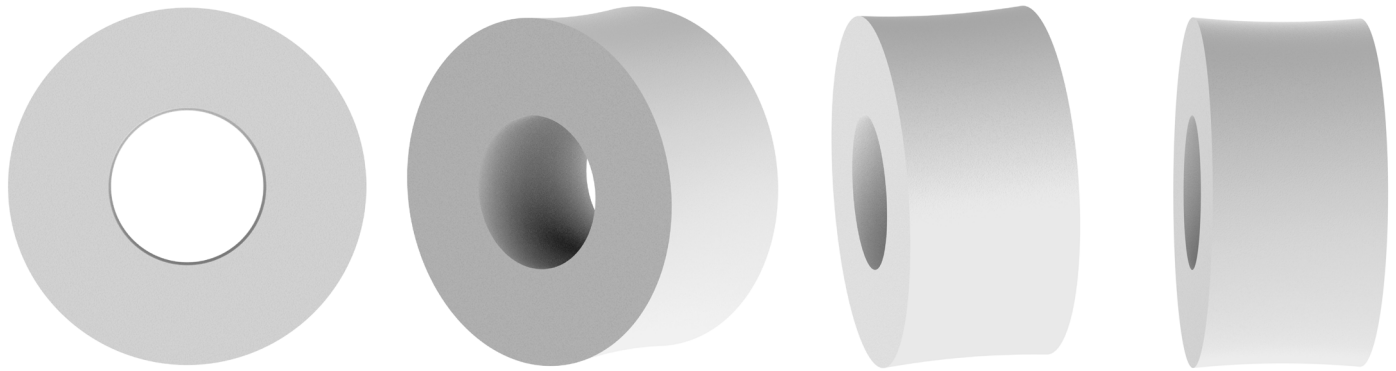

**NEW &
IMPROVED!**

1960-1966 Chevy & GMC Truck

Glove Box Hinge Bushing

• OD 0.622", ID 0.275", thickness 0.298"

110402 Glove Box Hinge Bushing 1 Pc. / Each

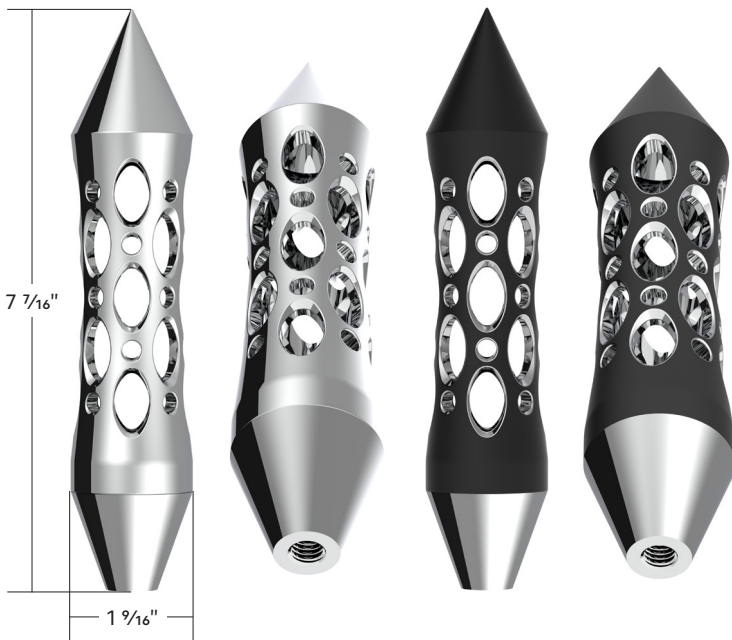

Daytona Style Spike Grip Handle With Beer Tap Adapter

- Beautiful chrome plated finish with triple chrome plating process
- High quality CNC machined grip handle and adapter
- Great add-on to any home bars, pub or restaurant draft beer faucet with 3/8"-16 male beer tap threads. (Faucet not included)

70892 **Chrome** 1 Pc. / Card

70893 **Black** 1 Pc. / Card

